



SSD2825 V3

28" Resizing LCD, Brightness is 1000 nits, LED backlight, 1366x254 ultra wide aspect ratio 16:3

SSD2825 V3 is an innovative ultra-wide, LED backlight LCD display. It provides LCD panel with specific ratios for digital signage, public transportation, exhibition hall, department store, vending machine and industrial applications.

Key Features

- Resizing LCD
- Ultra Wide Screen (16 : 3)
- LED Backlight
- High Brightness 1000nits
- Wide Viewing Angle
- Low Power Consumption
- High Uniformity
- Wide Dimming
- Life Expectancy



Specifications

Preliminary

Model No.	SSD2825 V3
Description	28" Resizing LCD, 1000nits, LED backlight, 1366x254
Display Area	697.7 x 129.7 mm
Brightness	1000nits
Resolution	1366 x 254
Aspect Ratio	16 : 3
Contrast Ratio	3000:1
Pixel Pitch (mm)	0.51 x 0.51
Viewing Angle	178°(H), 178°(V)
Display Colors	16.7M
Response Time (Typical)	6.5 ms
Power Consumption	28W
Dimensions (mm)	745.6x183.3x51.5mm (w/o Handle)
Weight (Net)	5.8Kg
LED Driving Board	LID28A04
Control Board (Optional)	<input type="checkbox"/> AD2662GD
<input type="checkbox"/> AD2662GD	VGA+DVI
F / R Control Button	<input type="checkbox"/> 4 Key
<input type="checkbox"/> 4 Key	Power Switch, Menu, Select (+,-),
OSD Menu	Brightness, Contrast, H/V Position, Color, Phase, Clock...
Optional	<input type="checkbox"/> AOT <input type="checkbox"/> Touch Screen

Specifications are subject to change without notice.

All brands or product names are trademarks or registered trademarks of their respective companies.

SSD= Panel+ LED Driving Board + Control Board + Housing



Mechanical Drawing

Panel Outline Dimensions

Unit: mm

Note :

O.D. : Outline Dimension

B.O. : Bezel Opening

A.A. : LCD Active Area

A : 4-M4_SCREW_Max Depth=5 mm

B : 4-M6_SCREW_Max Depth=7 mm

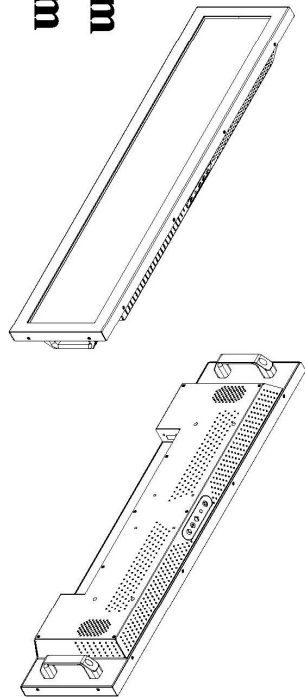

MEMBRANE 4-KEY

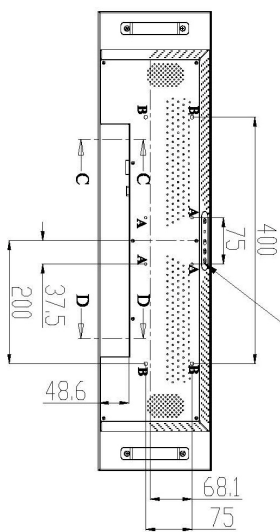
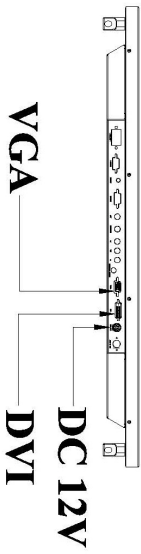
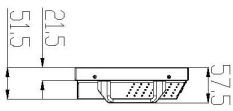
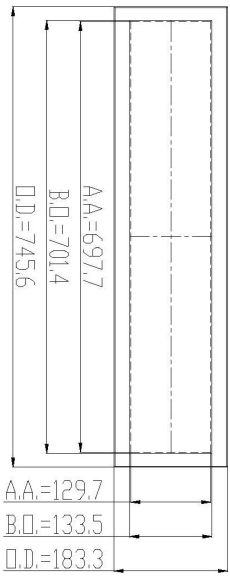
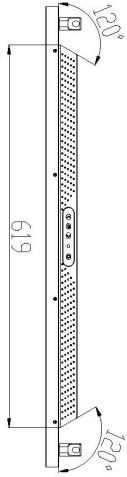
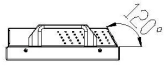

剖视图 C-C
Scale 2:1



剖视图 D-D
Scale 2:1



Ordering Information

Part Number	Description
SSD2825-ENB-G21	28",1000nits,1366*254,O/B,AD2662GD, DC 12V,V03

Optional Accessories

Part Number	Description
840612051210	ADAPTER,AC/DC,12V/5.4A,65W,Atech OEM A065112-TDx,4P SLIDING CAP,P
810618301010	CABLE.POWER.AC.1830mm USA type
810618301090	CABLE,POWER,AC,1830mm Europe type
810618301050	CABLE.POWER.AC.1830mm UK type
810618301170	CABLE.POWER,AC,1830mm Australia type
810618301030	CABLE.POWER.AC.1830mm Japan type